

SAFETY ELECTRIC ACTUATOR SA05RBP

GENERAL CHARACTERISTICS

The SA05RBP electric actuator is used on ¼ turn valves. The maximum output torque is 50 Nm.

With its battery emergency shut-off device, it is designed to the electrical actuation of safety valves. Indeed, if there is a cut in the electric actuator power supply, it automatically brings the valve to the NO or NC position. This reset function should remain EXCEPTIONAL and limited to emergencies. Its compact construction with an epoxy coated aluminium enclosure (protection IP 67) makes it convenient for actuation on ball valves and butterfly valves. 3 point actuator.

IP 67



LIMITS OF USE

Protection rating	IP 67
Temperature range	-10 °C / +60 °C
Service	S2 - 70%
Battery check	Once every 6 months

MECHANICAL CHARACTERISTICS

Gears	Steel
Torque	50 Nm
Manual override	6 mm Allen key
ISO 5211 pad	Star drive nut 14
Position indicator	LED (opening and closing)
Torque limiter	Mechanical end stops



ELECTRICAL CHARACTERISTICS

Motor protection	Thermal cut-out	Anti-condensation	2 W heater
Limit switches	2 adjustable switches	Electrical connection	Gland pack M20x1.5 (not supplied)
Auxiliary limit switches	2 auxiliary dry switches	Cutting capacity	250 V - 3 A max.

CONSTRUCTION

Enclosure	Epoxy coated aluminium
Cover	Epoxy coated aluminium
Gears, Stem, Cams	Steel

The following data is for information purpose only and may be subject to alteration without prior notice

	SECTORIEL S.A. 45, rue du Ruisseau 38290 Saint Quentin-Fallavier – FRANCE Tel.: +33 474 94 90 70 – Fax: +33 474 94 13 95 www.sectoriel.fr / email: sectoriel@sectoriel.fr	Pages	1/2
	Ref.	FT23060 GB	
	Rev.	2	
	Date	10/2011	

SAFETY ELECTRIC ACTUATOR SA05RBP

DIMENSIONS (mm)

Item	A	B	C	D	E	F
SA05RBP	132	208	44	194	168	72

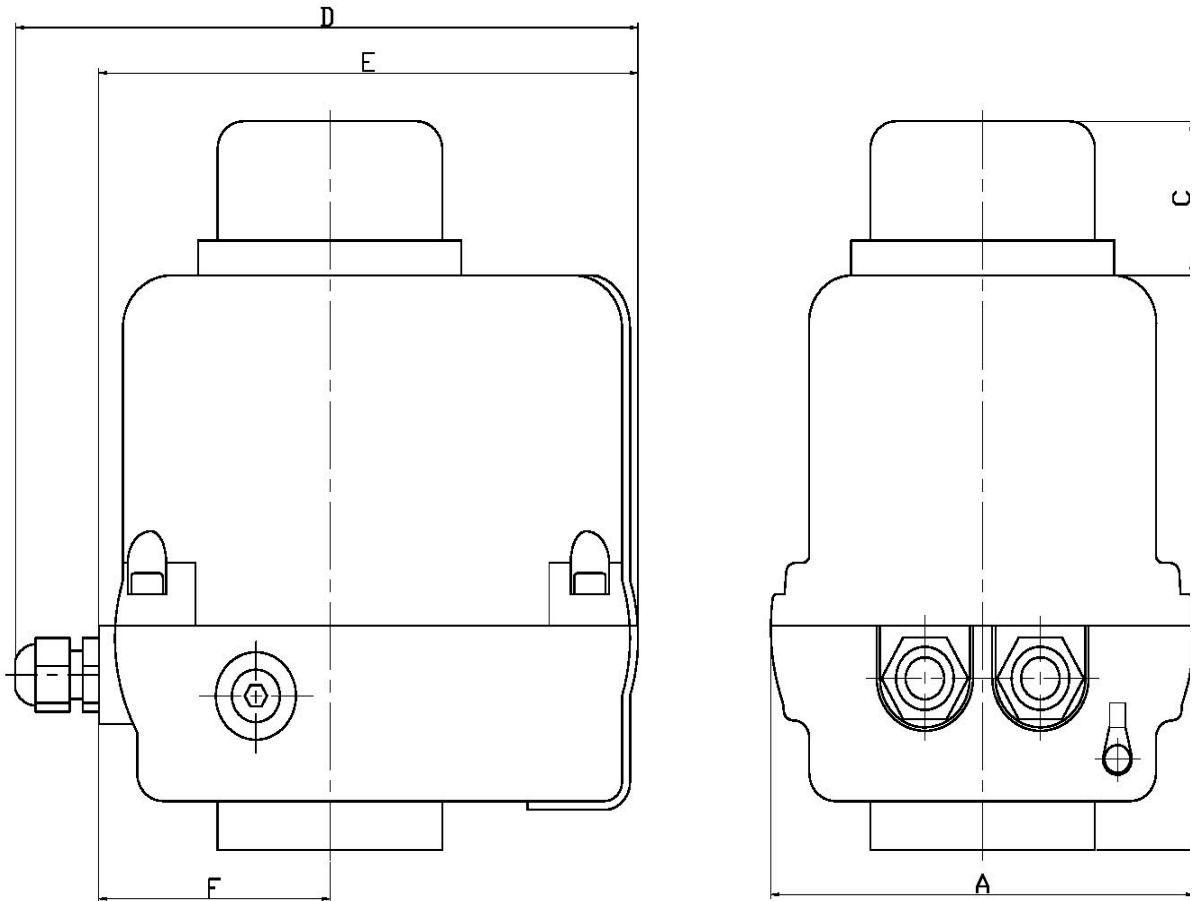

OTHER CHARACTERISTICS

Electric actuator	SA05RBP
Voltage	230 V AC
Power	6 W
Torque	50 Nm
Operating time	17 s
ISO 5211 pad	F03/F05/F07
Star drive nut	14 mm

INSTALLATION, MAINTENANCE AND ADJUSTMENTS

See Operation and Maintenance Instruction Manual #IME23060

The following data is for information purpose only and may be subject to alteration without prior notice

	SECTORIEL S.A. 45, rue du Ruisseau 38290 Saint Quentin-Fallavier – FRANCE Tel.: +33 474 94 90 70 – Fax: +33 474 94 13 95 www.sectoriel.fr / email: sectoriel@sectoriel.fr	Pages	2/2
		Ref.	FT23060 GB
		Rev.	2
		Date	10/2011